

1

Enter the license

EN

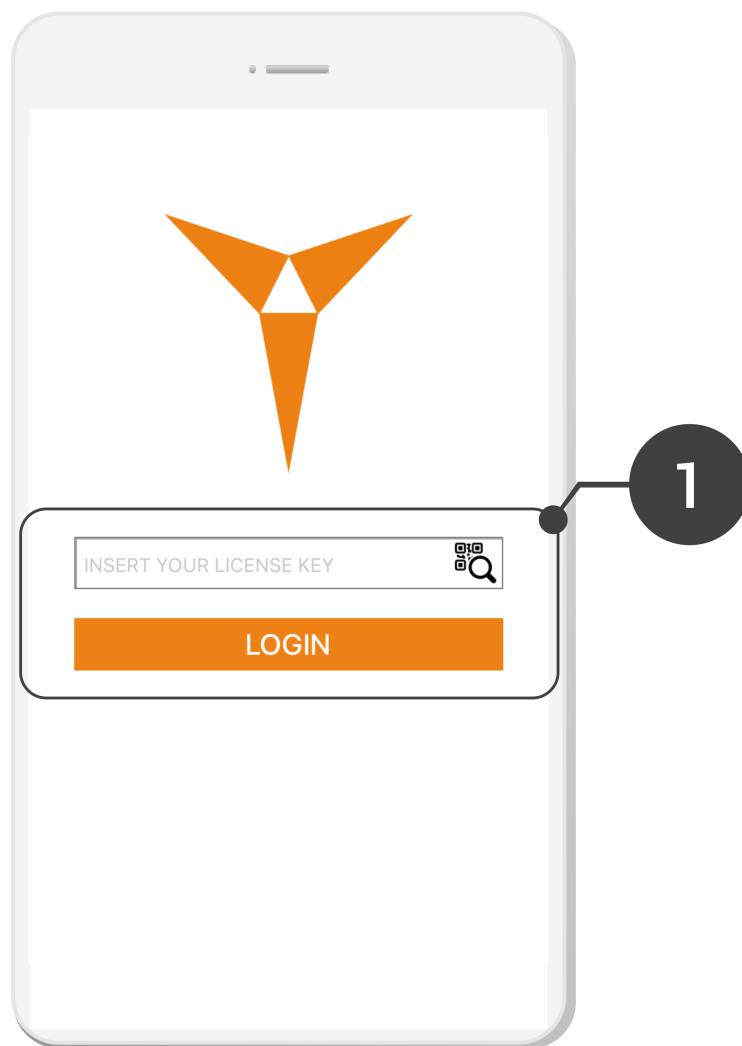

2

Select the button

EN

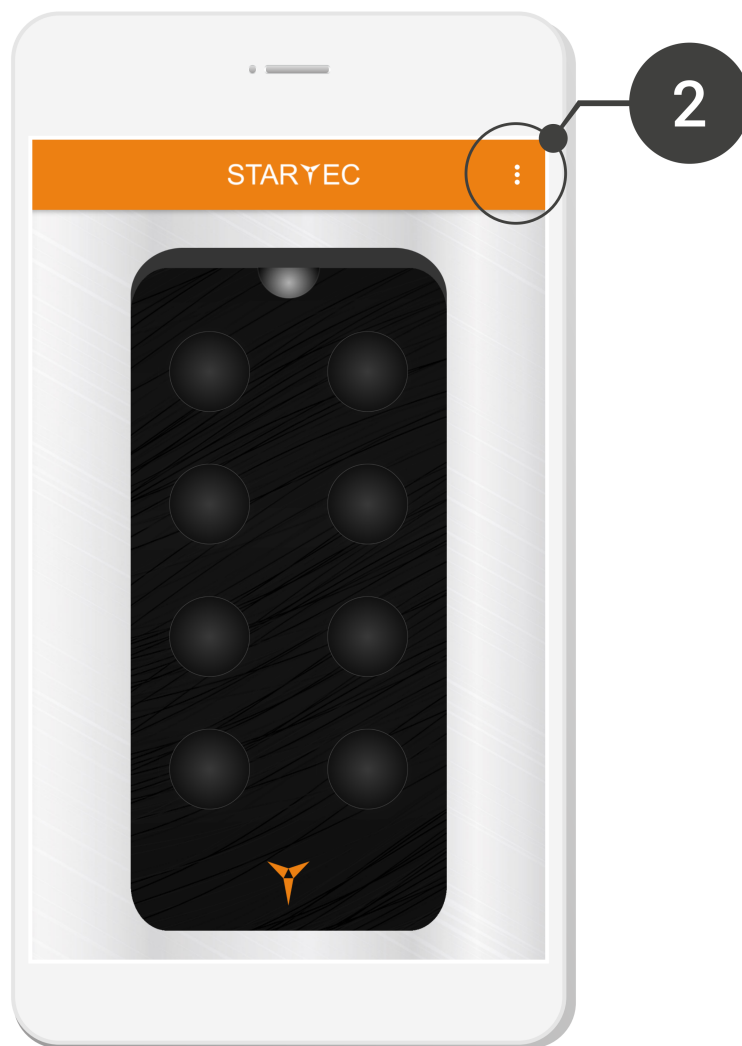

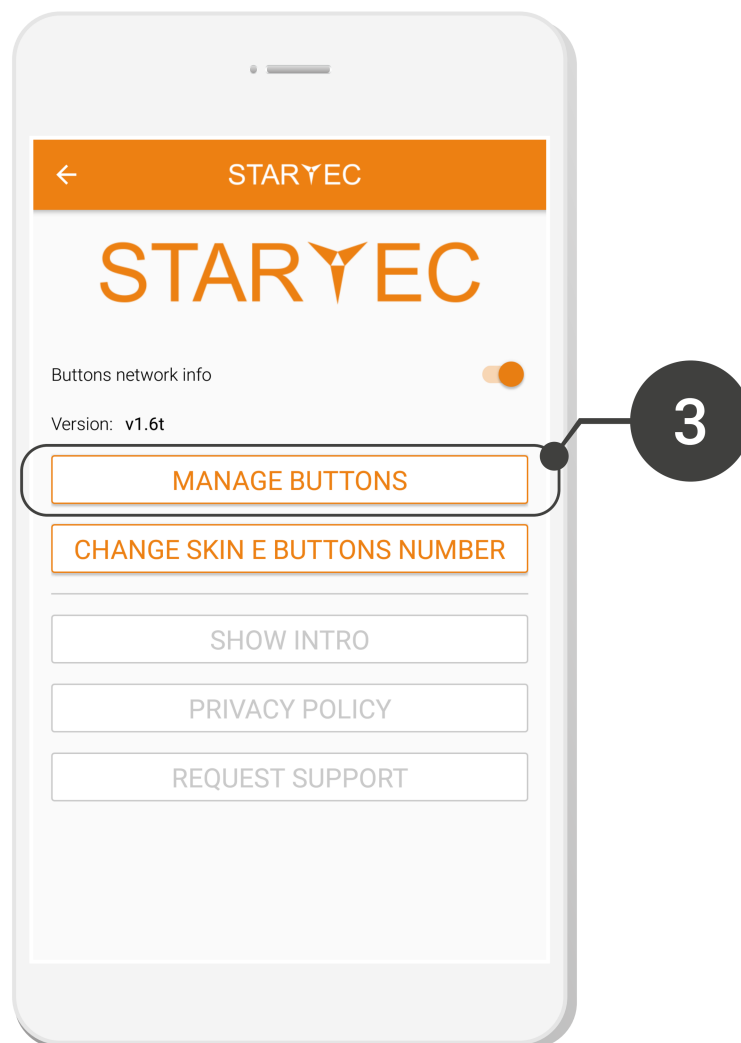

4

Select the button to configure

EN

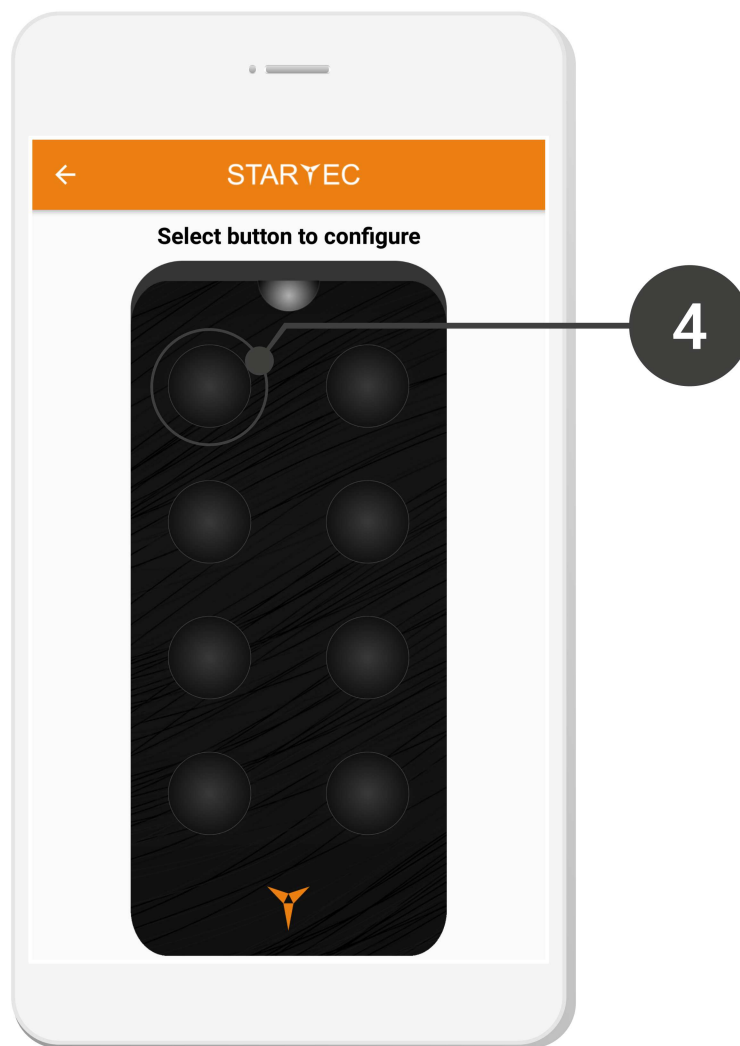

5

Select action type. We recommend: Start

EN

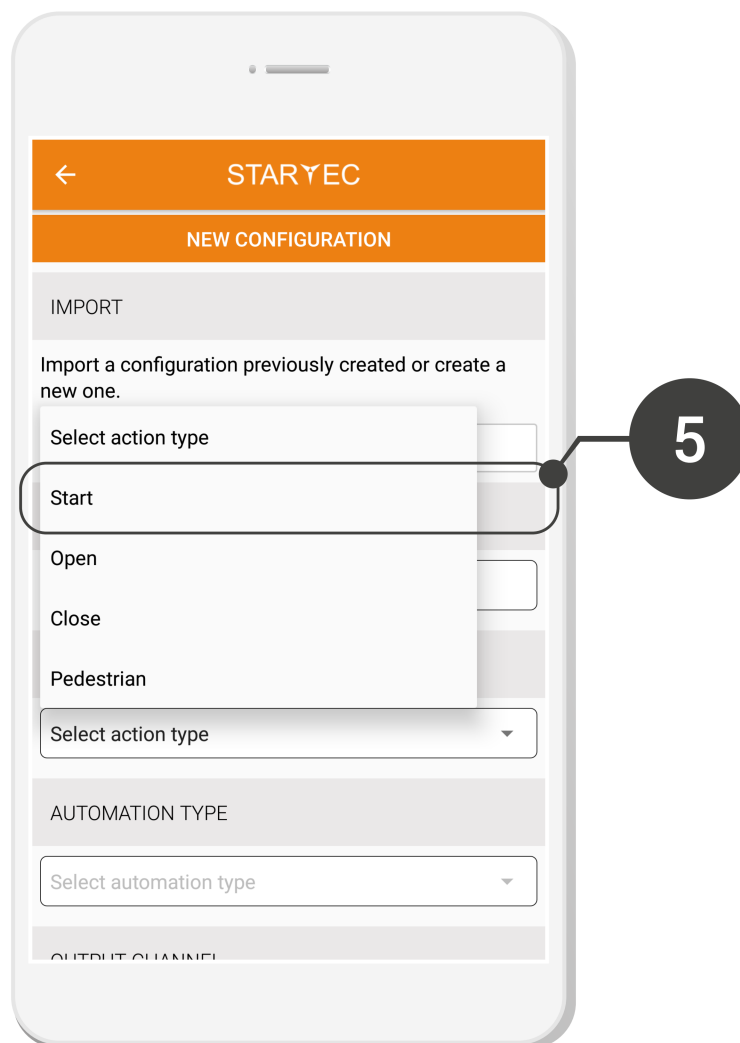

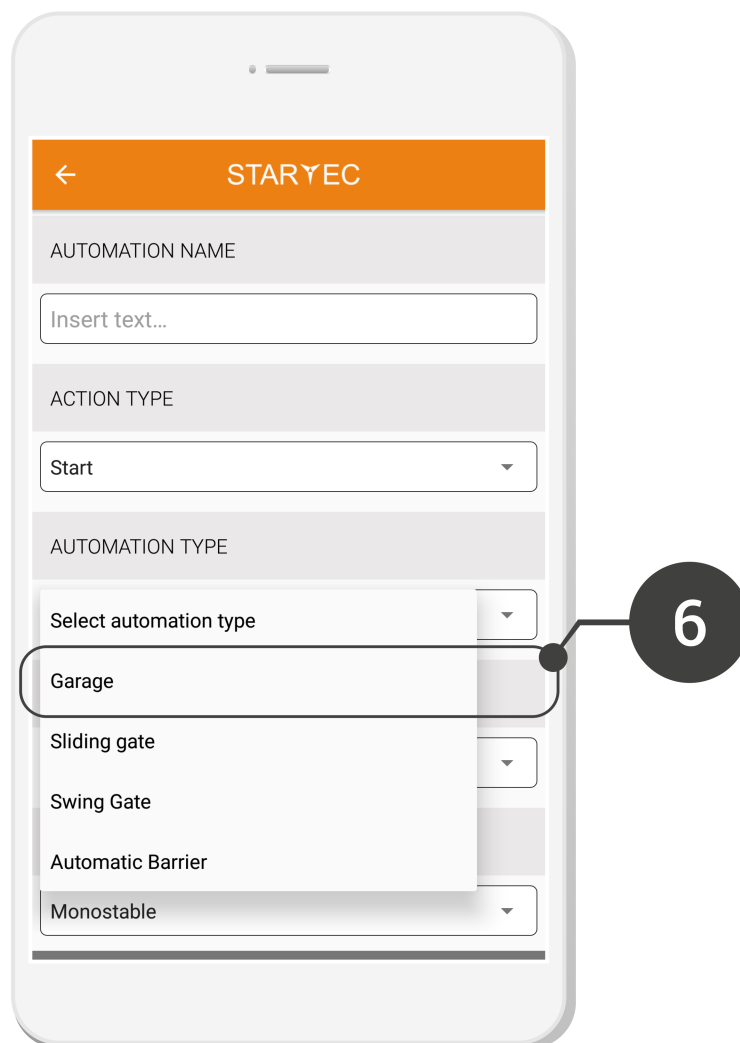

7

Select the output channel and the pilotage type

EN

The image shows a smartphone screen with the STARTEC application interface. The screen displays several configuration fields:

- AUTOMATION NAME:** A text input field with the placeholder "Insert text...".
- ACTION TYPE:** A dropdown menu currently set to "Start".
- AUTOMATION TYPE:** A dropdown menu currently set to "Garage".
- OUTPUT CHANNEL:** A dropdown menu currently set to "Ch 1". This field is highlighted with a callout circle labeled "7A".
- PILOTAGE TYPE:** A dropdown menu currently set to "Monostable". This field is highlighted with a callout circle labeled "7B".

The top of the screen features a navigation bar with a back arrow and the text "STARTEC".

8

Type the SSID that is on the wifi receiver and password

EN

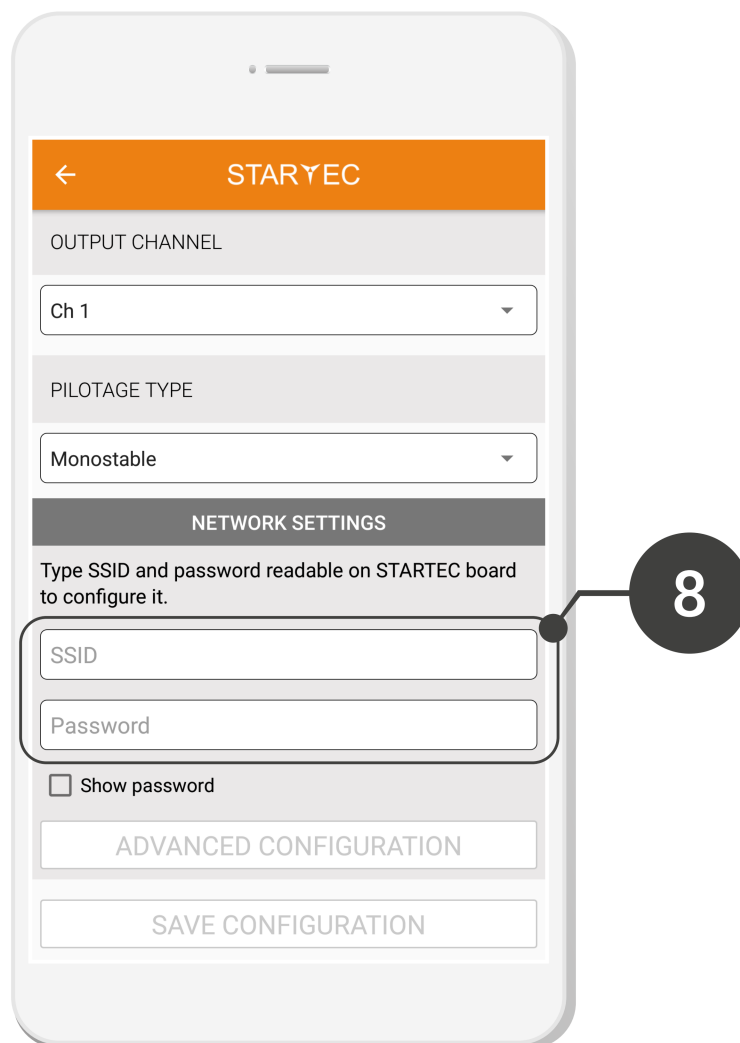

The screenshot shows the STARTEC mobile application interface. At the top, there is a back arrow and the text "STARTEC". Below this, the "OUTPUT CHANNEL" is set to "Ch 1" and the "PILOTAGE TYPE" is set to "Monostable". The "NETWORK SETTINGS" section is highlighted with a dark header. It contains the instruction: "Type SSID and password readable on STARTEC board to configure it." Below this instruction are two input fields: "SSID" and "Password". A checkbox labeled "Show password" is present below the password field. At the bottom of the screen, there are two buttons: "ADVANCED CONFIGURATION" and "SAVE CONFIGURATION". A callout bubble with the number "8" points to the SSID and Password input fields.

Change your password:

For security reasons, after you have connected to the wifi network, we suggest you change the password (min. 5 chars)

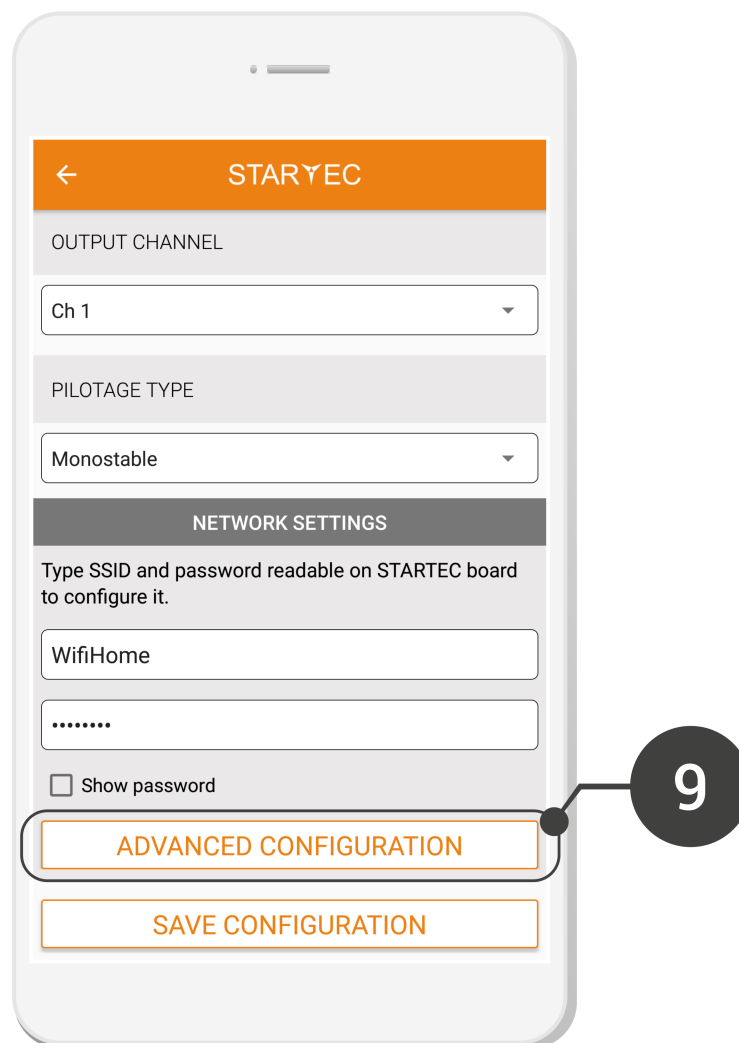

You have completed the configuration

← STARTEC

OUTPUT CHANNEL

Ch 1

PILOTAGE TYPE

Monostable

NETWORK SETTINGS

Type SSID and password readable on STARTEC board to configure it.

WifiHome

.....

Show password

ADVANCED CONFIGURATION

SAVE CONFIGURATION

10

11

Remote control ready

EN



Remove the configured button:

“manage buttons”, select the button to remove and confirm with “remove from the remote control”

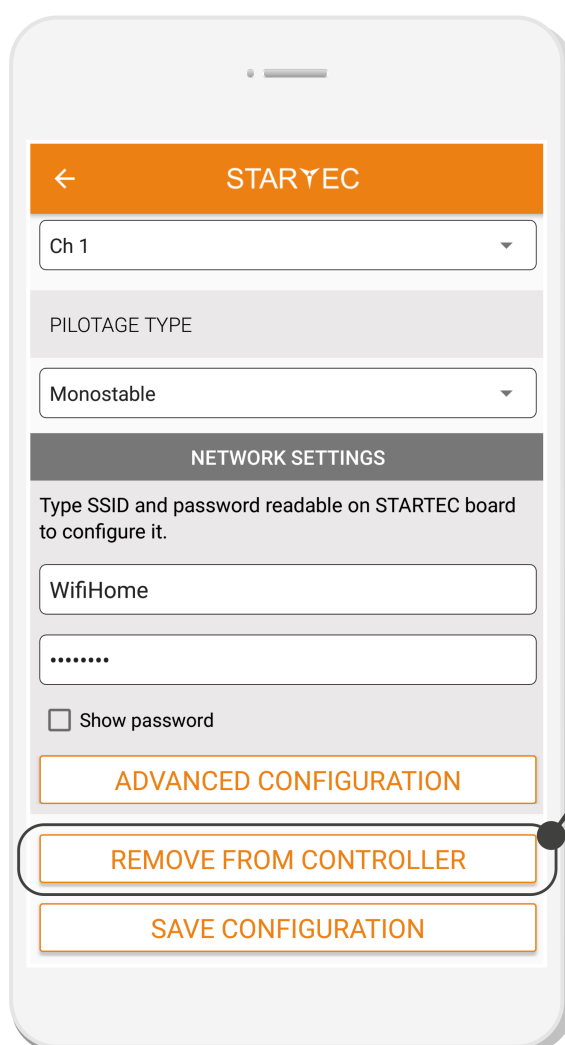



SmartControl



STARTEC
www.startec-automazioni.it